

Concord Carlisle Regional High School – Campus Advisory Committee

PUBLIC INPUT MEETING

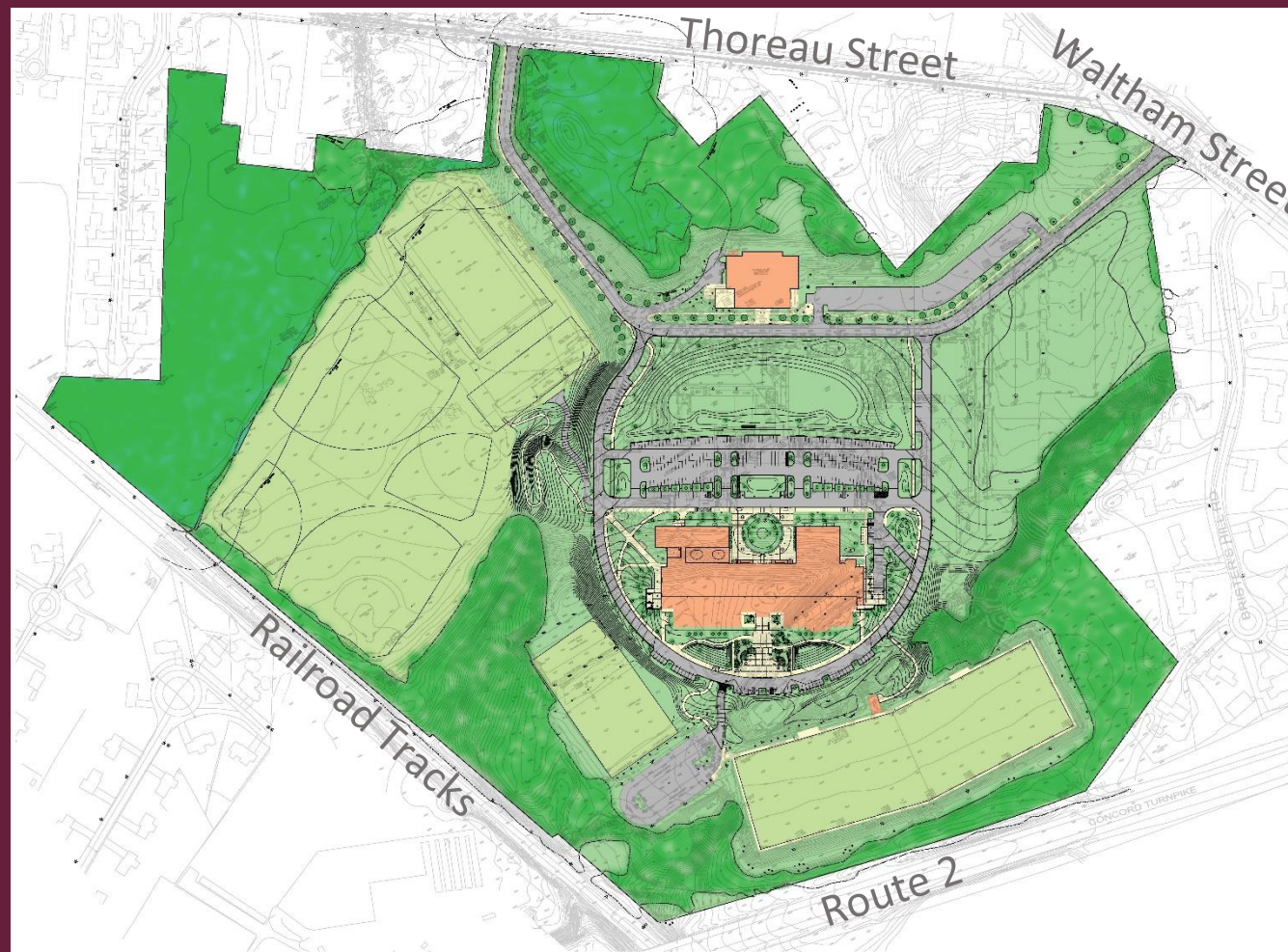

January 24, 2018

CCHS Campus Advisory Committee



CCHS Campus Advisory Committee AGENDA

- Call to Order
- Protocol/Rules of Engagement
- Public Input
- Adjournment (8:30pm)



What We'll Cover

- Campus Advisory Committee (CAC) Charge
- Public Engagement Plan
- Existing Conditions and Users
- Evaluation Process
- Public Input





CAC CHARGE

CAC CHARGE

- Concord-Carlisle High School (CCHS) facility is to serve the educational needs of our students
- Facilities are also used by various other entities
- Therefore, in order to maximize our investment in the facilities

CAC is to study the current and potential future use of the property



January 24, 2018

CCHS Campus Advisory Committee



CAC CHARGE

- CAC Recommendations:
 - Advisory in nature
 - Consistent with our school and district core values
 - Based on input from Students, the Superintendent, Principal, the Concord and Carlisle communities, and other stakeholders
- CAC recommendations to CCRSC → Final Decisions



CAC CHARGE

Membership:

- 2 CCRSC members (one each from Concord and Carlisle)
- Superintendent
- CCHS Principal
- Deputy Superintendent
- Facilities Manager
- Athletic Director
- 1 CCHS Teacher
- Concord Town Manager or designee
- 1 Concord Recreation Commission member or designee
- 3 CCHS Students
- 3 Community members-at-large, which may include parents from Boston, Carlisle or Concord, providing diversity of interests and expertise



CAC CHARGE

Membership:

- Mary Storrs, Chair
- John Boynton, Vice Chair
- Susan Ludi Blevins
- Kathleen Ogden Fasser
- John Flaherty
- Bob Grom
- Barry Haley
- Laurie Hunter
- Ryan Kane
- Alexander Kessler
- Mike Mastrullo
- Mary McCabe
- Brian Miller
- Ravin Nanda
- Brian Schlegel
- Kay Upham
- Hannah Yelle





PUBLIC ENGAGEMENT PLAN

PUBLIC ENGAGEMENT PLAN

Level of Engagement: Collaborate (includes informing and consulting with the community)

	Inform	Consult	Collaborate	Partner
Engagement Goal:	To provide stakeholders with factual, balanced, and timely information to help them understand the project.	To obtain stakeholder feedback on project analysis, alternatives, or decisions.	To work directly with the public throughout the process to ensure that perspectives are consistently understood, considered, and reflected in project decisions.	To partner with stakeholders in each aspect of decision making in order to develop and implement collaborative project solutions.

Concord-Carlisle Regional School Committee
CCHS Campus Advisory Committee

PUBLIC ENGAGEMENT PLAN - December 2017

(In preparation of developing this Public Engagement Plan (PEP), a working group convened to discuss the study and set goals for decision making. To this end, the working group developed a Draft Rubric to which proposed ideas will be evaluated (see attached). This Rubric then guided the engagement techniques that are outline below.)

Charge of the Campus Advisory Committee

The primary purpose of the Concord-Carlisle High School (CCHS) facility is to serve the educational needs of our students. In addition to serving our students, the facilities are also used by various other entities, including Adult and Community Education, youth sports groups, Concord Town Meeting, and others. In order to maximize our investment in the facilities, the Concord-Carlisle Regional School Committee (CCRSC) is forming a CCHS Campus Advisory Committee (CAC) to study the current and potential future use of the property. There are a number of potential land-use oriented projects that will need careful analysis, planning and implementation.

This Committee will be advisory in nature and will solicit input from Students, the Superintendent, Principal, the Concord and Carlisle communities, and other stakeholders. Recommendations from the Committee are not binding on the CCRSC and should be consistent with our school and district core values. The CCRSC is responsible for making any final decisions related to the use of CCRSD facilities.

Purpose of this Document

The Purpose of this Public Engagement Plan (PEP) is to describe and outline the various public engagement efforts that will inform the CAC. This document identifies outreach strategies for authentic engagement, as well as methods and tools for reaching target audiences. It also describes the roles of key groups that will be involved in the process. The Draft PEP may be updated or revised following consultation with CAC and stakeholder groups. A preliminary schedule of engagement activities is included.

Engagement Goals

It is the goal of the CAC to promote authentic engagement of the community in this study. There are many levels at which a CAC might engage the CCHS and greater Concord, Carlisle and Boston Communities. For this study the CCRSC and the CAC is looking to **Collaborate** with the public (which also includes informing and consulting with the community).



PUBLIC ENGAGEMENT PLAN

LIST OF STAKEHOLDERS

Students

Teachers

Coaches

School Building Administrators (Principal, Asst. Principals, AD)

Central District Administration (Superintendent, Deputy Superintendent, Facilities Manager)

Town of Carlisle

Town of Concord, Town Mgr, Asst Town Mgr

Concord Town Meeting

Concord Recreation Department

Concord Public Works, Parks and Grounds

CCHS neighborhood residents

Community-at-large

Beede Center

Adult and Community Education

Concord Commission on Disability

CCYS Soccer

CCYS Football

CCYS Baseball/Softball

CCYS Lacrosse

CCYS Basketball

CCYS Hockey

Adult Sports Teams

Friends of CC Playing Fields

Summer Camps

Solar Committee

Skateboard park

CC Pops

Camps in HS building

Other sports/activities that need to go off campus

Summer Clinics/Camps (STAR)

Middle School Sports Teams

Private Schools (CA Middlesex, Fenn, Nashoba)

Concord Academy (AD)

Middlesex School (AD)

Fenn School (AD)

Nashoba Brooks School (AD)



PUBLIC ENGAGEMENT PLAN

OUTREACH STRATEGIES

Public Information:

<http://www.concordps.org/school-committee/campus-advisory-committee/>

- Fact Sheet
- CCHS E-mail Blasts
- CCHS Forums
- Site Walk (December 19th)
- Public Input Meetings
- Request For Ideas (RFI)

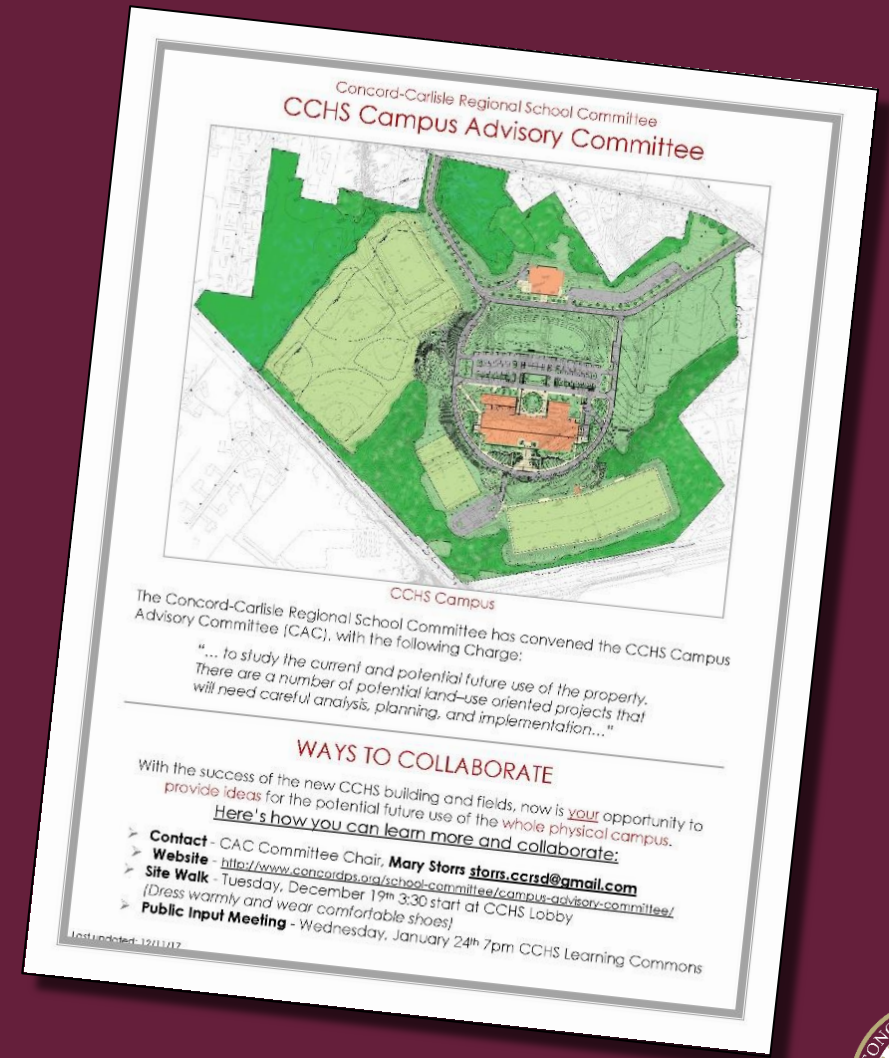

PUBLIC ENGAGEMENT PLAN

Date	Time	Description	Location
December 19, 2017	3:30pm	Site Walk	CCHS Lobby
December 19, 2017	5:00pm	CAC Meeting	CCHS Learning Commons
January 18, 2018	5:00pm	CAC Meeting	CCHS Learning Commons
January 24, 2018	7:00pm	CAC Meeting – Public Input Meeting #1	CCHS Learning Commons
January 30, 2018	5:00pm	CAC Meeting	CCHS Learning Commons
February 13, 2018	5:00pm	CAC Meeting	CCHS Learning Commons
Early March?	TBD	CAC Meeting – Public Input Meeting #2	TBD
March 20, 2018	5:00pm	CAC Meeting	CCHS Learning Commons
April 10, 2018	5:00pm	CAC Meeting	CCHS Learning Commons
May 8, 2018	5:00pm	CAC Meeting	CCHS Learning Commons
May 22, 2018 (?)	6:30pm	CAC Presentation to CCRSC	Ripley Building



January 24, 2018

CCHS Campus Advisory Committee





EXISTING CONDITIONS & USERS

EXISTING CONDITIONS

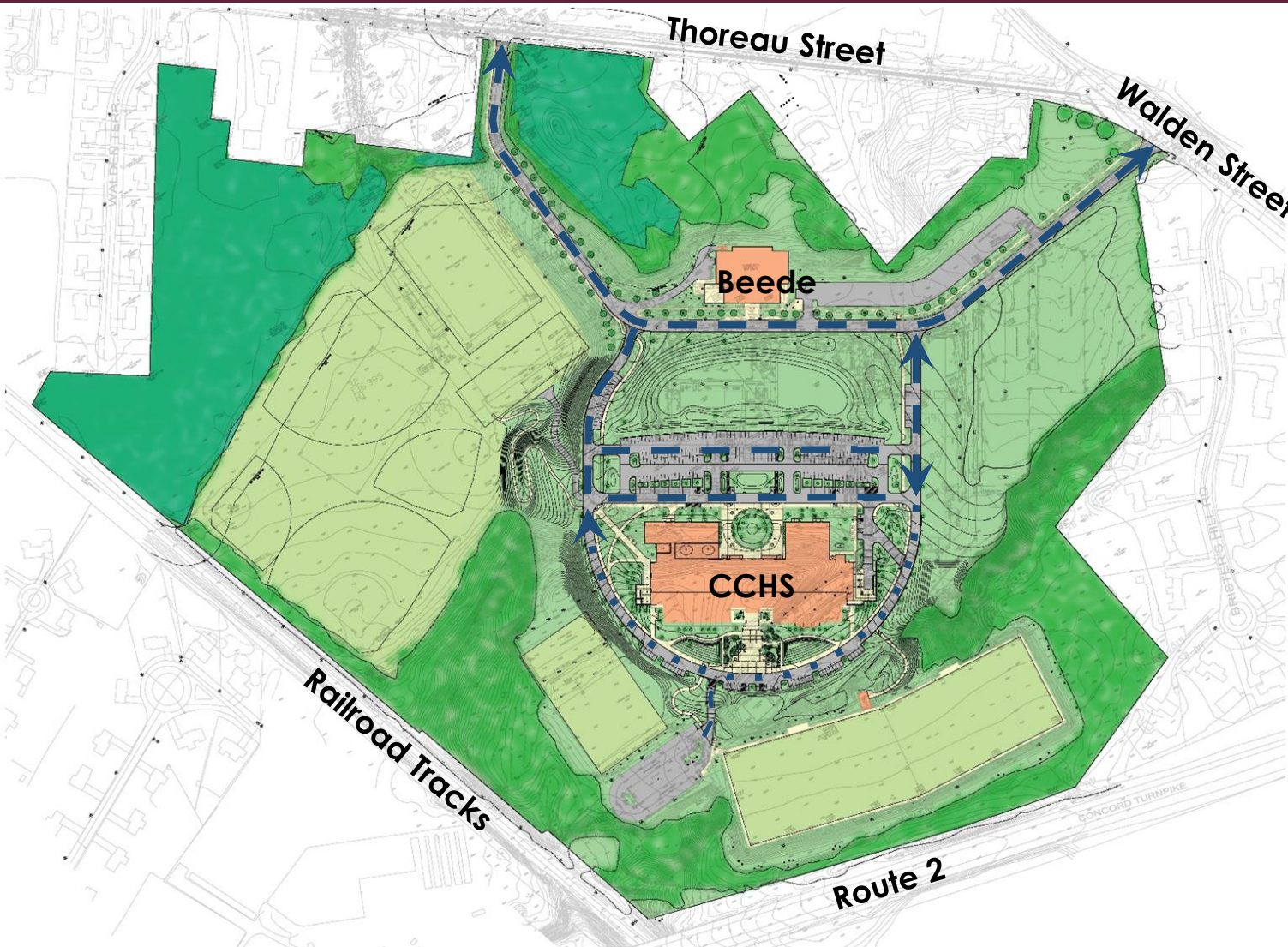

EXISTING FIELD USERS

CCHS Sports

Football

Flag Football

Adult Soccer

Lacrosse

CCYS

Concord Recreation

Star Camp

Target Soccer

Concord Rec Summer



EXISTING CONDITIONS

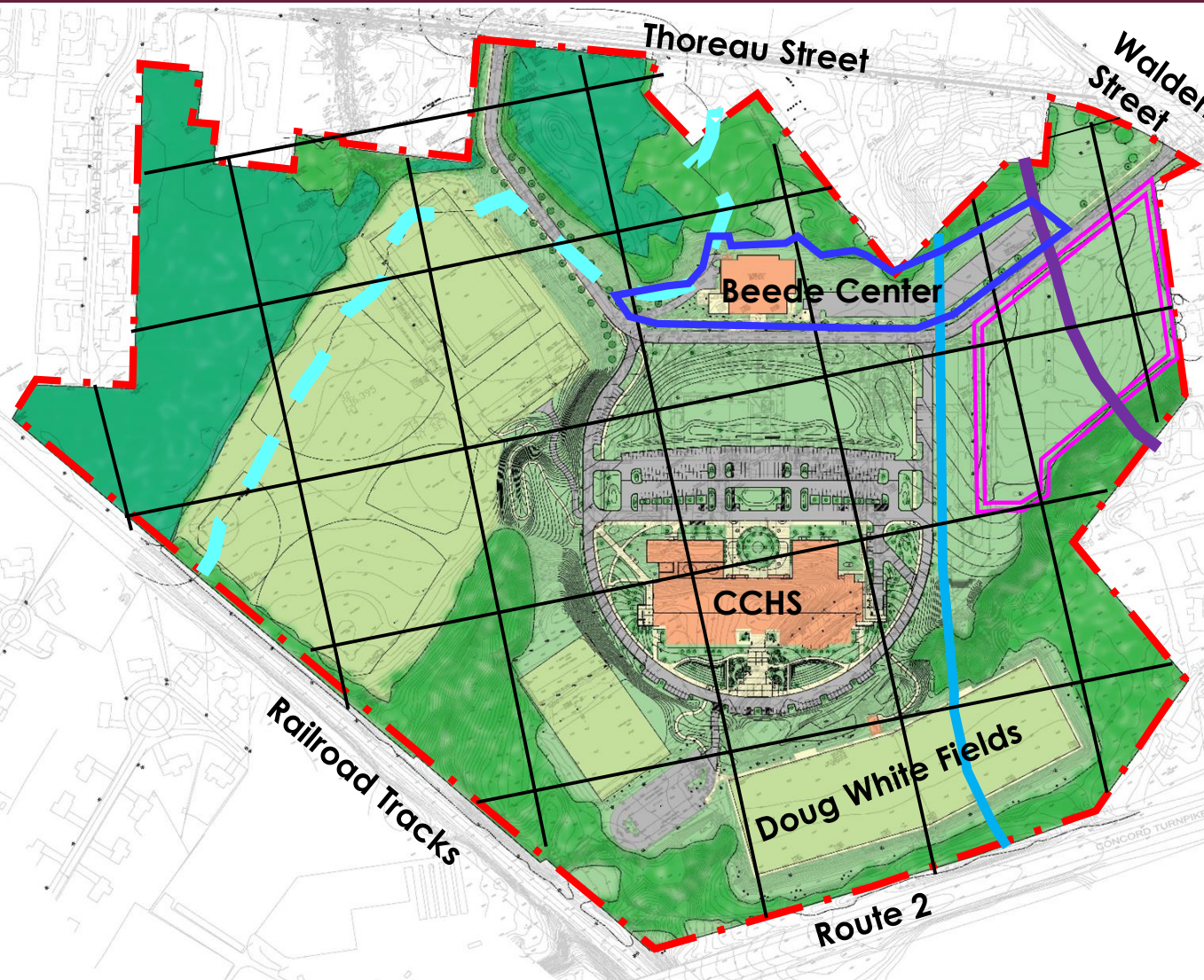



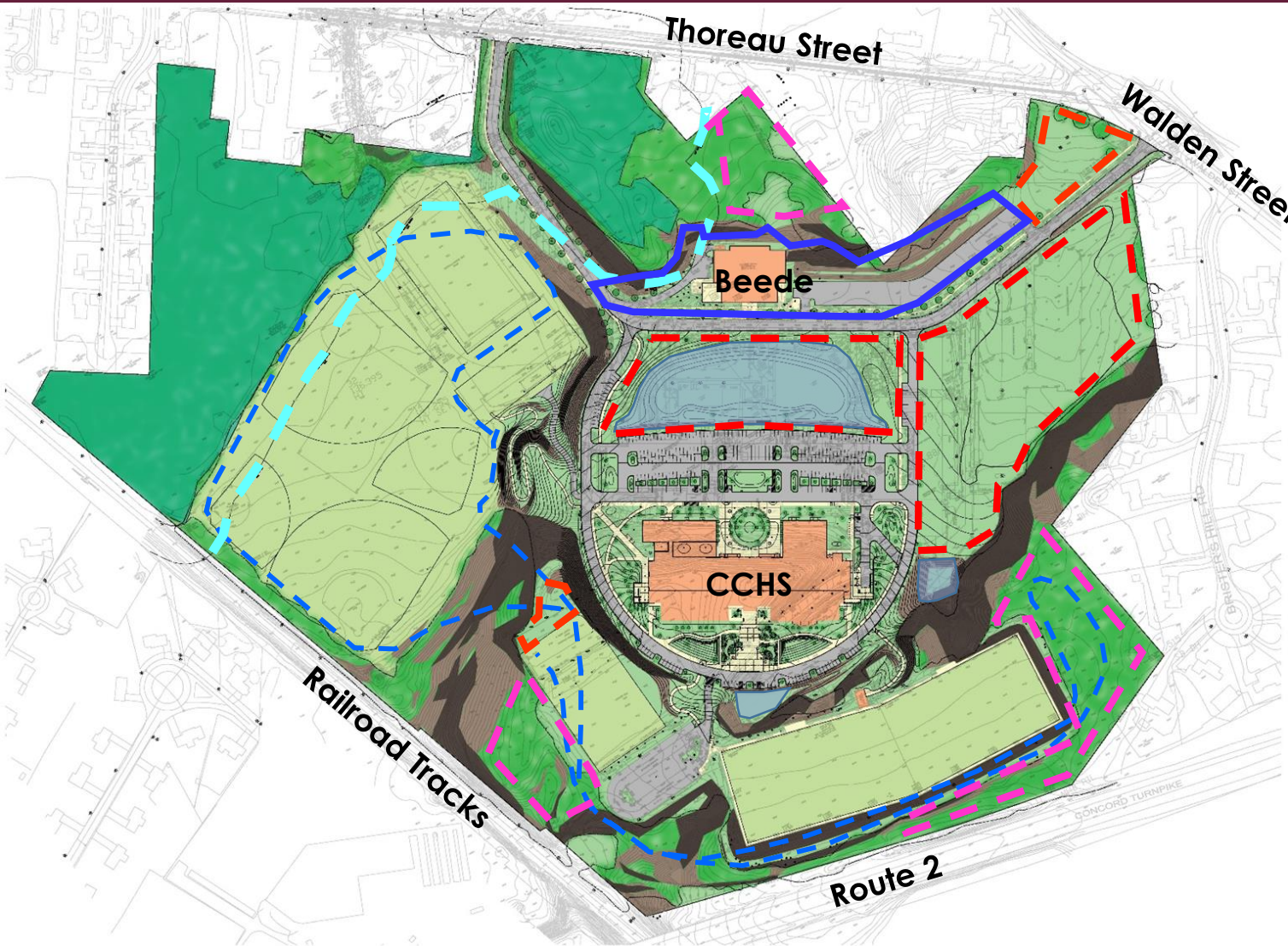

- Property Line ±93.76 acres
- Wetland Buffer Zone
- Zone II Water Protection Area
- High Yield Aquifer
- Medium Yield Aquifer
- Beede Center Lease Area
- Landfill Area

Residential Zone A for Educational Use,
Wetlands Conservancy District &
Groundwater Conservancy District

EXISTING CONDITIONS



-  Slopes over 15% (unbuildable)
-  Slopes 8-15%
-  Detention Basins
-  Cross-country route

REMAINING USEABLE LAND:

-  -Wooded
-  -Not wooded

LANDFILL ACTIVITY USE LIMITATIONS (AUL)

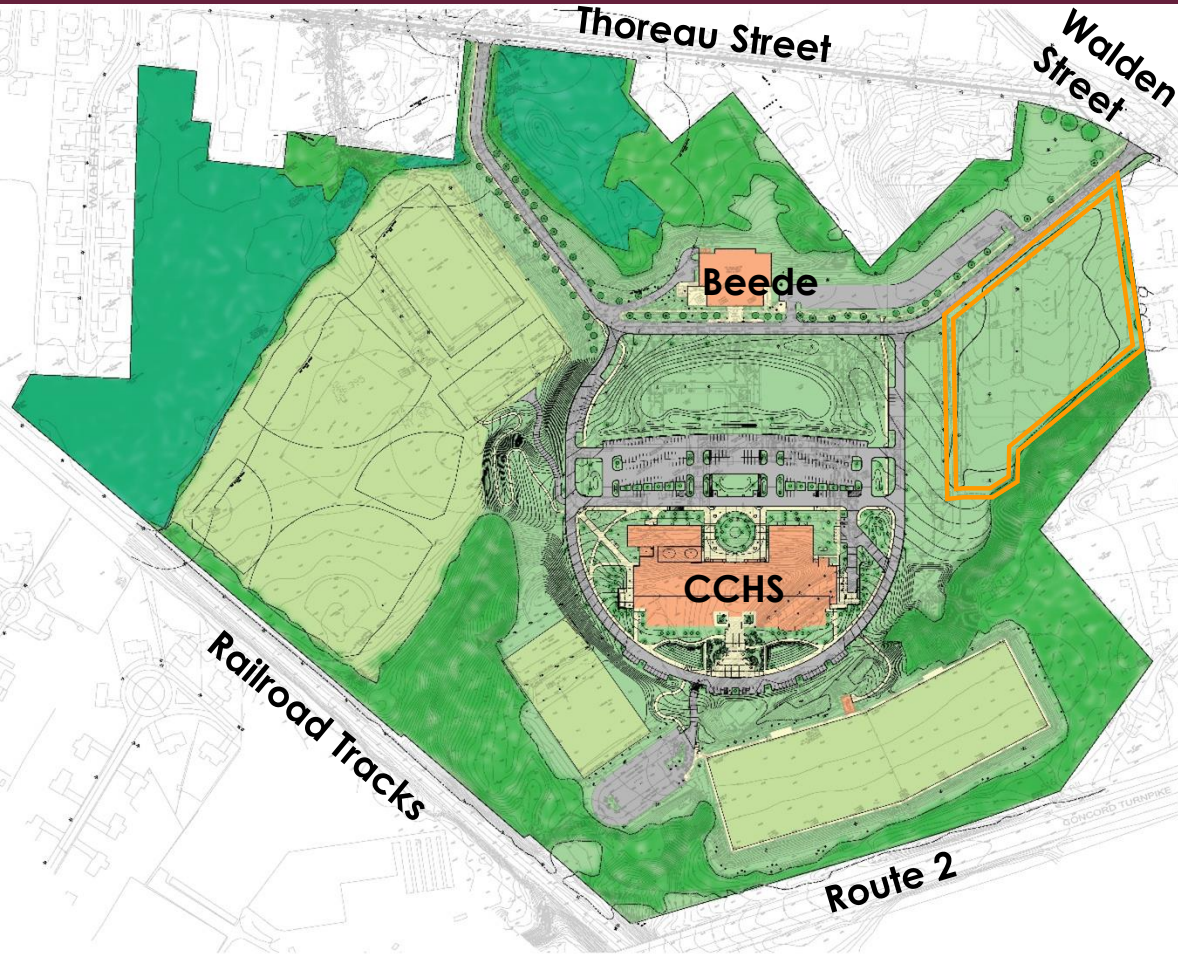

- Permanent Solution - 22" soil cap
- No Significant Risk
- Restriction of human access to and contact with ... soil and ... the restriction of activities occurring in, on, through, over or under the [landfill] = AUL

LANDFILL ACTIVITY USE LIMITATIONS (AUL)

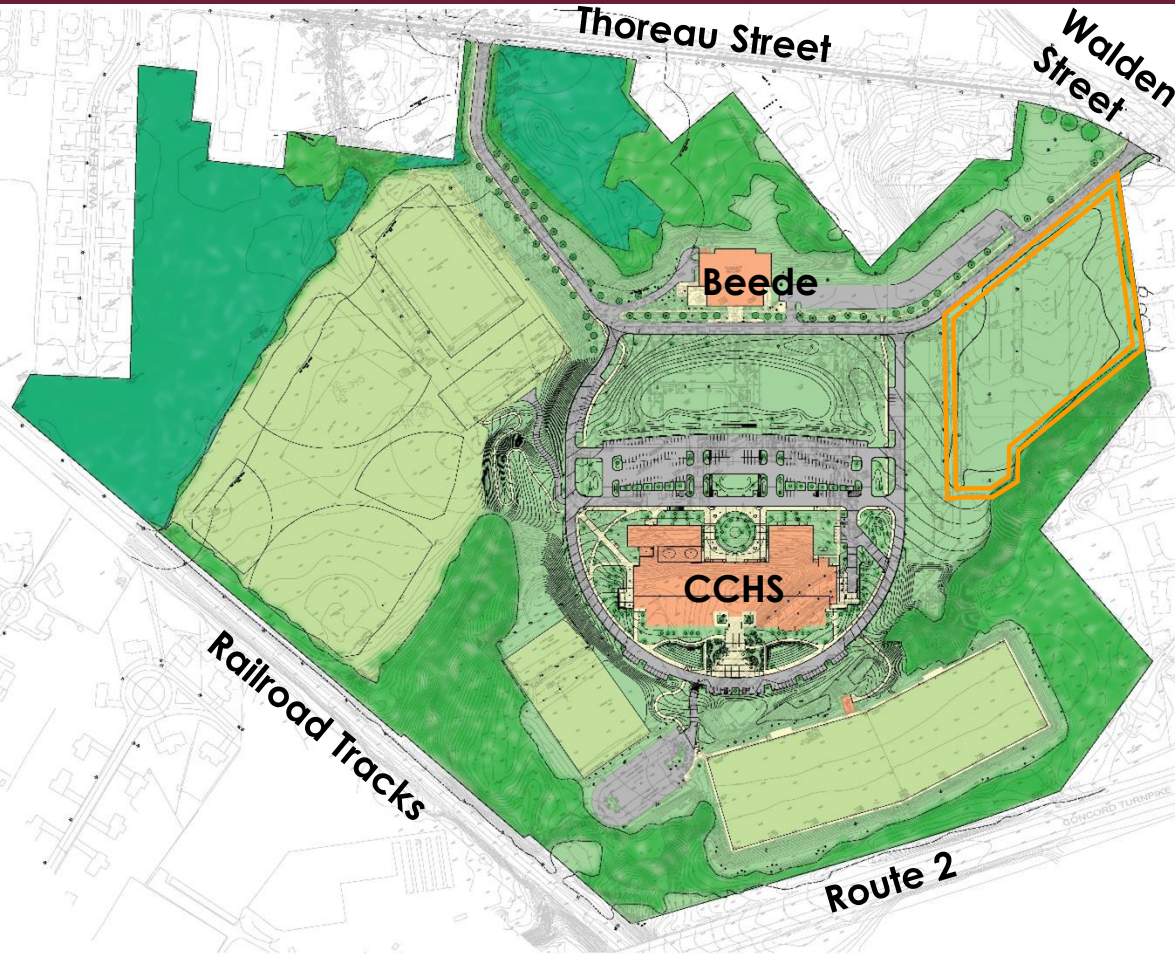

Activities Consistent with maintaining a Permanent Solution:

- Passive uses that do not disturb the capped material, including but not limited to vacant lot, parking area, paving, park, recreational area

Activities NOT Consistent with maintaining a Permanent Solution:

- Uses that disturb or penetrate the capped material, including but not limited to residence, agriculture, deep rooted plantings, excavation that disturbs the capped material





EVALUATION PROCESS

EVALUATION PROCESS

ALL IDEAS ARE WELCOME

- Solicit input (PEP)
- Standardize, augment input
- Evaluate options (Rubric)
- Make recommendation to CCRSC



EVALUATION RUBRIC

- Educational Impact
- Community Building
- Costs
- People Benefitted
- Physical Development
- Sustainability
- Revenue Generating

Project Idea:		Limited (1)	Developing (2)	Meeting Standard (3)	Exemplary (4)
Educational Impact (2x multiplier)					
Academic					
Athletic					
Performing Arts					
Fine Arts					
Responsible Citizenship					
Category Subtotal					
Community Building					
School Community					
Greater CC Community					
Category Subtotal					
Cost					
Understanding of Construction Cost					
Validity of Estimate					
Funding Sources					
Funding Identified					
Understanding of Maintenance Costs					
Feasibility of Funding					
Category Subtotal					
Numbers					
Students (2x multiplier)					
Community					
User Groups					
Category Subtotal					
Physical Space					
Site Plan / Layout					
Aesthetic Goals					
Parking					
Mitigating Actions					
Category Subtotal					
Sustainability					
Building the Project					
Energy					
Other					
Category Subtotal					
Revenue Generating					
Potential to generate revenue					
Category Subtotal					
Proposal Total					

INFORMAL REQUEST FOR IDEAS (RFI)

- Informal
- Based on Evaluation Rubric
- Standardize input
- Augment ideas as appropriate
- All ideas will be included in report to the CCRSC

Concord-Carlisle Regional School Committee
CCHS Campus Advisory Committee

REQUEST FOR IDEAS

This RFI is provided by the CCHS Campus Advisory Committee (CAC) to provide a formal for ideas for potential future improvements to the CCHS campus. Please fill in as much information as possible. Please be as concise as possible. If you need additional space feel free to attach additional sheets. If specific information is not available, please leave it blank. The CAC may contact you for clarifications or more information. If you have any questions regarding this RFI form, please contact CAC Chair Mary Stors at stors.carsd@psd1.com.

Project Idea Name: _____

Submitted By: _____ Organization _____ Interest Group _____

Contact Information:

Name _____ Phone Number _____ Email _____

Date: _____ Revisions: _____

1. What Educational Impact will this idea provide? (Consider academic, athletic, performing arts, fine arts, responsible citizenship, other)

Page 1 of 3

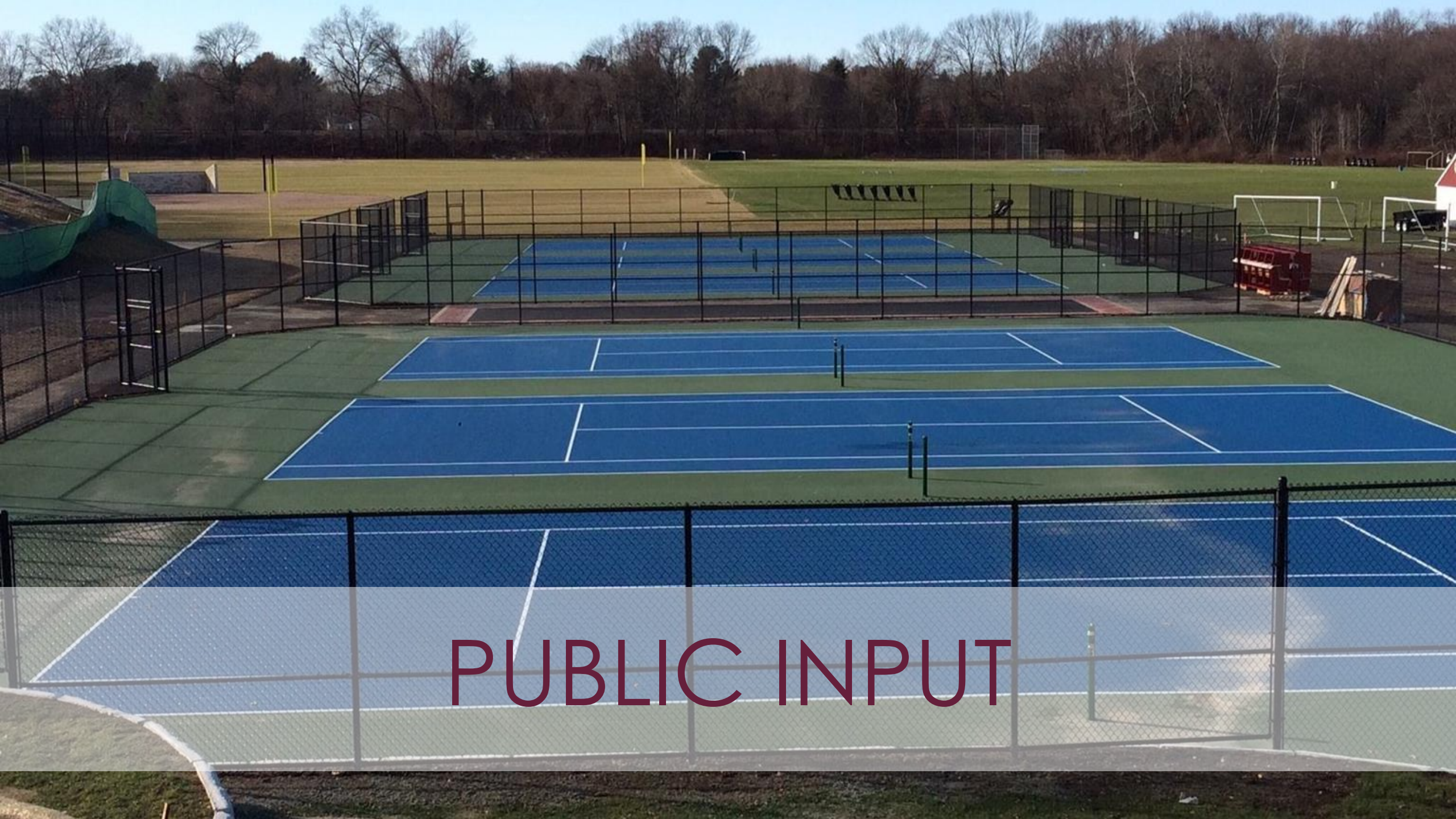

PUBLIC INPUT

INPUT RECEIVED TO DATE

- Amphitheatre
- Bonfire
- Garden
- Parking
- Pavilion
- Practice fields
- Running track
- Skating rink
- Solar panels
- Walking paths



PUBLIC INPUT

- All ideas have value
- Consider the entire campus
- Listen, don't debate
- Keep on point



THANK YOU

Keep up with us here:

<http://www.concordps.org/school-committee/campus-advisory-committee/>



The screenshot displays the website for Concord-Carlisle Regional School District. The header includes the district's name and a search bar. A navigation menu lists various departments. The main content area features a sidebar with links to the School Committee and its subcommittees, and a section for the latest news. The main body of the page is dedicated to the CCHS Campus Advisory Committee, with links for committee charge and membership, meeting schedule, documents, and public engagement.

Concord
PUBLIC SCHOOLS

Concord-Carlisle
REGIONAL SCHOOL DISTRICT

Search our resources...

Administration Schools School Committee Curriculum Contact Resources

Explore More

School Committee

- Current Fiscal Year Meetings
- Meeting Archives
- Advisory and Sub Committees
 - CCHS Campus Advisory Committee
 - Budget Subcommittee
 - Policy Subcommittee
- School Committee Updates
- School Committee Reports
- School Committee Policy Manual
- Contact School Committee

Latest News

2018-2019 Calendar Forum and CCHS Campus Advisory Input Meeting
12-22-2017

The Joint School Committees invite you to:
2018-2019 School Calendar Forum Tuesday,
January 9, 2018 6:00-7:00 p.m. Rinear Building

CCHS Campus Advisory Committee

COMMITTEE CHARGE AND MEMBERSHIP >

MEETING SCHEDULE, AGENDAS AND MINUTES >

DOCUMENTS >

PUBLIC ENGAGEMENT v

January 24, 2018

CCHS Campus Advisory Committee

